

Glazing Details

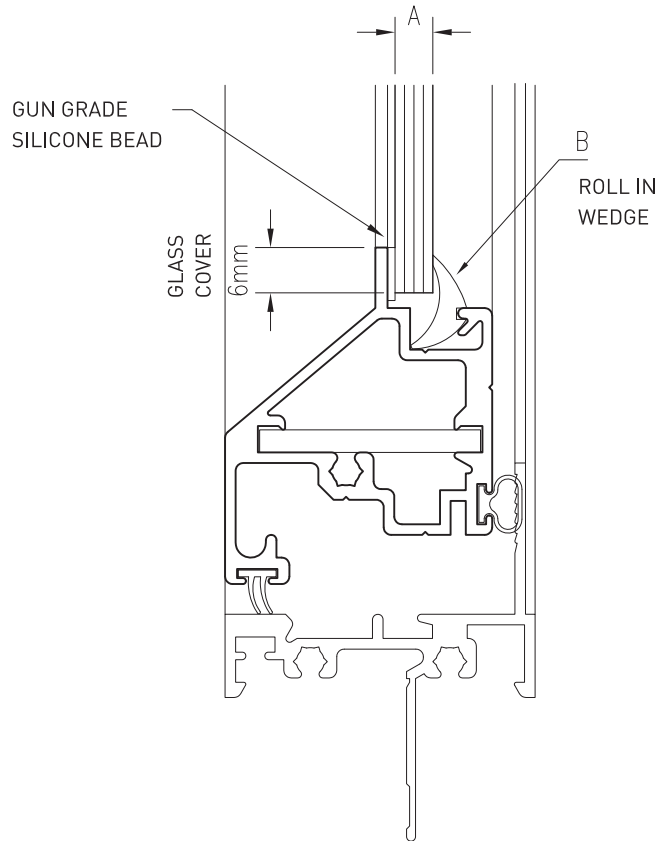

A (Glass Thickness)	B (Glazing Wedge)	Material
3mm-6.38mm	04-073	PVC

Assemble sash in the horizontal plane, with the wedge face up, ensuring the assembly is square. Gun a small continuous bead of silicone sealant against the glazing leg. Position the glass into the rebate against the silicone, ensuring that similar edge clearance is maintained all round the glass. Roll in wedge ensuring that corners meet firmly. Handle gently and carefully. Lay sash down with PVC wedge face up, to ensure pressure on silicone bead, to allow silicone to cure. Do not transport vertically for 12 hours after glazing.

This glazing detail does not comply with AS1288 Table 8.1.

Glazing Details

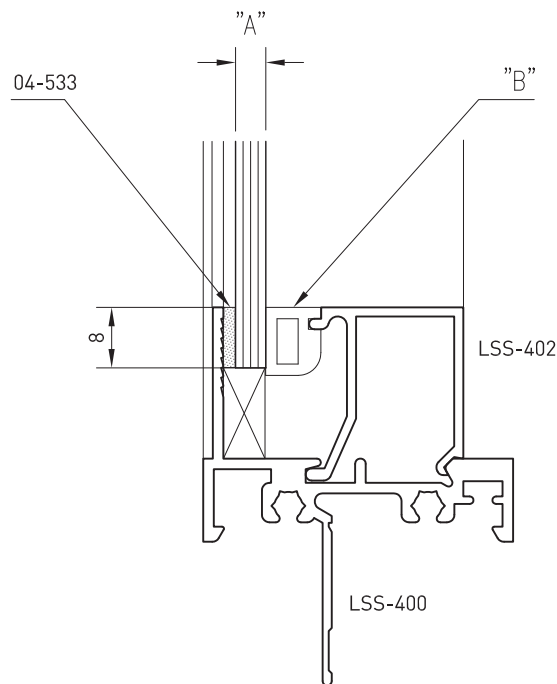

A (Glass Thickness)	B (Glazing Wedge)	Material
3mm	04-523	PVC
4mm	04-524	PVC
5mm	04-525	PVC
6mm/6.38mm	04-526	PVC

Assemble frame in the horizontal plane, with the wedge face up, ensuring the assembly is square. Apply glazing tape against the glazing leg. Position the glass into the rebate against the tape, ensuring that similar edge clearance is maintained all round the glass. Roll in wedge ensuring that corners meet firmly.