



DESIGNER RANGE 424 SYSTEM

Thermaview™ Double Hung Window

Specifier Guide

The Lidco Specifier's Guide contains technical information, maximum permissible sizes, typical configurations, energy ratings and key design features and benefits.



Typical Configurations

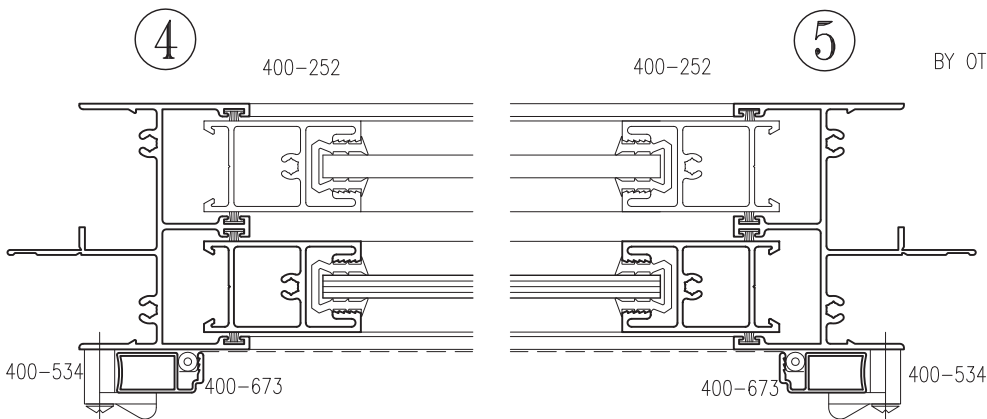
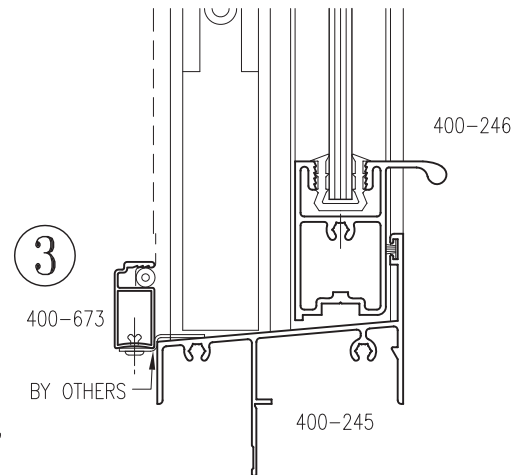
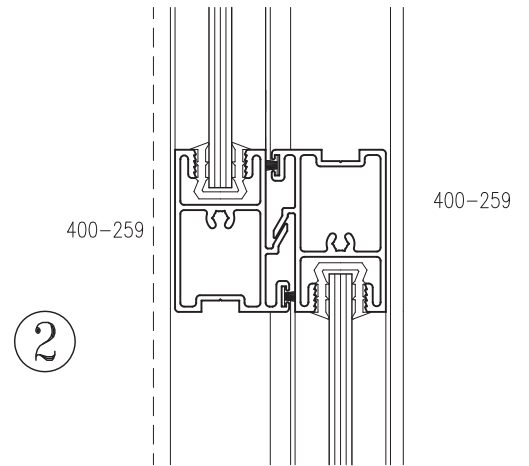
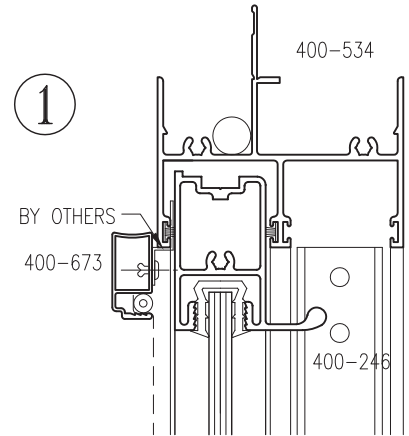
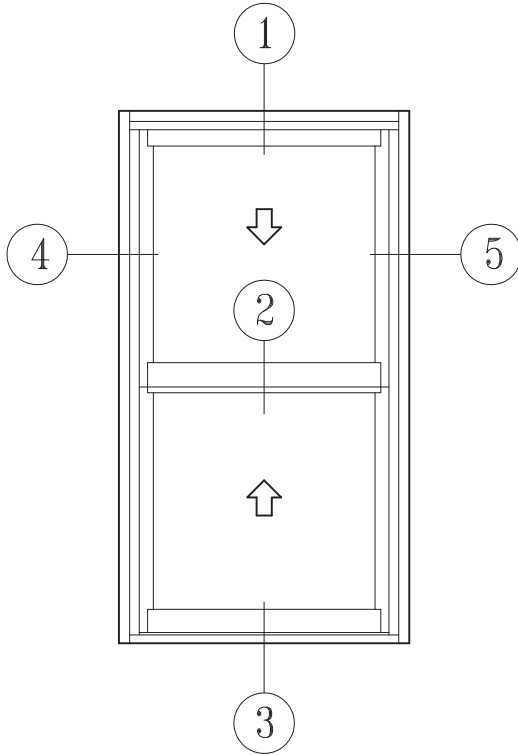

Loading Tables

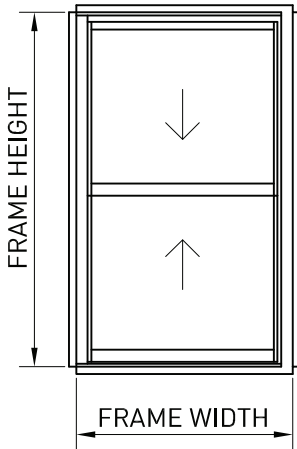

The following calculations are based on theoretical section properties, not on approved tests as specified by AS2047. The Design Wind Pressure is used to calculate the theoretical maximum panel size and does not account for Water Penetration. For more detailed information on suitability please contact Lidco directly.

Residential Deflection ratio, K = 180
Commercial Deflection ratio, K = 250

INTERLOCK TYPE 1 - RESIDENTIAL

Frame Width	900	1000	1100	1200	1300	1400	1500
Frame Height							
1000	3.0kPa	3.0kPa	2.2kPa	1.5kPa	1.5kPa	1.0kPa	1.0kPa
1100	3.0kPa	3.0kPa	2.2kPa	1.5kPa	1.5kPa	1.0kPa	0.7kPa
1200	3.0kPa	3.0kPa	2.2kPa	1.5kPa	1.0kPa	1.0kPa	0.7kPa
1300	3.0kPa	3.0kPa	2.2kPa	1.5kPa	1.0kPa	1.0kPa	0.7kPa
1400	3.0kPa	3.0kPa	2.2kPa	1.5kPa	1.0kPa	1.0kPa	0.7kPa
1500	3.0kPa	3.0kPa	2.2kPa	1.5kPa	1.0kPa	0.7kPa	0.7kPa
1600	3.0kPa	3.0kPa	1.5kPa	1.5kPa	1.0kPa	0.7kPa	0.7kPa
1700	3.0kPa	3.0kPa	1.5kPa	1.5kPa	1.0kPa	0.7kPa	0.5kPa
1800	3.0kPa	2.2kPa	1.5kPa	1.0kPa	1.0kPa	0.7kPa	0.5kPa
1900	3.0kPa	2.2kPa	1.5kPa	1.0kPa	1.0kPa	0.7kPa	0.5kPa
2000	3.0kPa	2.2kPa	1.5kPa	1.0kPa	1.0kPa	0.7kPa	0.5kPa
2100	3.0kPa	2.2kPa	1.5kPa	1.0kPa	1.0kPa	0.7kPa	0.5kPa
2200	3.0kPa	2.2kPa	1.5kPa	1.0kPa	1.0kPa	0.7kPa	0.5kPa
2300	3.0kPa	2.2kPa	1.5kPa	1.0kPa	0.7kPa	0.7kPa	0.5kPa

INTERLOCK TYPE 1 - COMMERCIAL

Frame Width	900	1000	1100	1200	1300	1400	1500
Frame Height							
1000	3.0kPa	2.2kPa	1.5kPa	1.5kPa	1.0kPa	0.7kPa	0.7kPa
1100	3.0kPa	2.2kPa	1.5kPa	1.0kPa	1.0kPa	0.7kPa	0.7kPa
1200	3.0kPa	2.2kPa	1.5kPa	1.0kPa	1.0kPa	0.7kPa	0.5kPa
1300	3.0kPa	2.2kPa	1.5kPa	1.0kPa	0.7kPa	0.7kPa	0.5kPa
1400	3.0kPa	2.2kPa	1.5kPa	1.0kPa	0.7kPa	0.7kPa	0.5kPa
1500	3.0kPa	2.2kPa	1.5kPa	1.0kPa	0.7kPa	0.5kPa	0.5kPa
1600	3.0kPa	2.2kPa	1.5kPa	1.0kPa	0.7kPa	0.5kPa	0.5kPa
1700	3.0kPa	1.5kPa	1.5kPa	1.0kPa	0.7kPa	0.5kPa	-
1800	3.0kPa	1.5kPa	1.0kPa	1.0kPa	0.7kPa	0.5kPa	-
1900	2.2kPa	1.5kPa	1.0kPa	1.0kPa	0.7kPa	0.5kPa	-
2000	2.2kPa	1.5kPa	1.0kPa	1.0kPa	0.7kPa	0.5kPa	-
2100	2.2kPa	1.5kPa	1.0kPa	1.0kPa	0.7kPa	0.5kPa	-
2200	2.2kPa	1.5kPa	1.0kPa	0.7kPa	0.7kPa	0.5kPa	-
2300	2.2kPa	1.5kPa	1.0kPa	0.7kPa	0.7kPa	0.5kPa	-

INTERLOCK TYPE 1

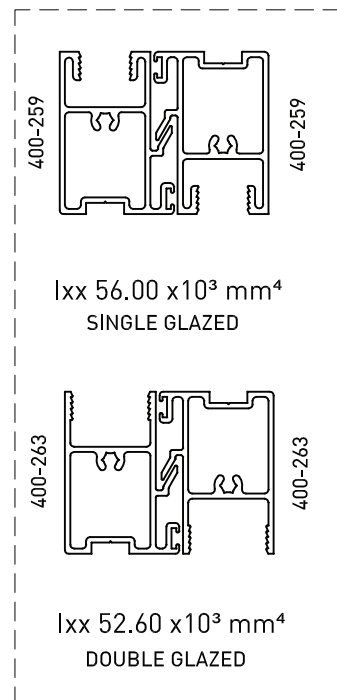

Loading Tables

INTERLOCK TYPE 2 - RESIDENTIAL

Frame Width	900	1000	1100	1200	1300	1400	1500
Frame Height							
1000	3.0kPa	3.0kPa	3.0kPa	3.0kPa	3.0kPa	3.0kPa	3.0kPa
1100	3.0kPa	3.0kPa	3.0kPa	3.0kPa	3.0kPa	3.0kPa	3.0kPa
1200	3.0kPa	3.0kPa	3.0kPa	3.0kPa	3.0kPa	3.0kPa	3.0kPa
1300	3.0kPa	3.0kPa	3.0kPa	3.0kPa	3.0kPa	3.0kPa	3.0kPa
1400	3.0kPa	3.0kPa	3.0kPa	3.0kPa	3.0kPa	3.0kPa	3.0kPa
1500	3.0kPa	3.0kPa	3.0kPa	3.0kPa	3.0kPa	3.0kPa	3.0kPa
1600	3.0kPa	3.0kPa	3.0kPa	3.0kPa	3.0kPa	3.0kPa	3.0kPa
1700	3.0kPa	3.0kPa	3.0kPa	3.0kPa	3.0kPa	3.0kPa	3.0kPa
1800	3.0kPa	3.0kPa	3.0kPa	3.0kPa	3.0kPa	3.0kPa	2.2kPa
1900	3.0kPa	3.0kPa	3.0kPa	3.0kPa	3.0kPa	3.0kPa	2.2kPa
2000	3.0kPa	3.0kPa	3.0kPa	3.0kPa	3.0kPa	3.0kPa	2.2kPa
2100	3.0kPa	3.0kPa	3.0kPa	3.0kPa	3.0kPa	3.0kPa	2.2kPa
2200	3.0kPa	3.0kPa	3.0kPa	3.0kPa	3.0kPa	3.0kPa	2.2kPa
2300	3.0kPa	3.0kPa	3.0kPa	3.0kPa	3.0kPa	3.0kPa	2.2kPa

INTERLOCK TYPE 2 - COMMERCIAL

Frame Width	900	1000	1100	1200	1300	1400	1500
Frame Height							
1000	3.0kPa	3.0kPa	3.0kPa	3.0kPa	3.0kPa	3.0kPa	3.0kPa
1100	3.0kPa	3.0kPa	3.0kPa	3.0kPa	3.0kPa	3.0kPa	3.0kPa
1200	3.0kPa	3.0kPa	3.0kPa	3.0kPa	3.0kPa	3.0kPa	2.2kPa
1300	3.0kPa	3.0kPa	3.0kPa	3.0kPa	3.0kPa	3.0kPa	2.2kPa
1400	3.0kPa	3.0kPa	3.0kPa	3.0kPa	3.0kPa	3.0kPa	2.2kPa
1500	3.0kPa	3.0kPa	3.0kPa	3.0kPa	3.0kPa	3.0kPa	2.2kPa
1600	3.0kPa	3.0kPa	3.0kPa	3.0kPa	3.0kPa	2.2kPa	2.2kPa
1700	3.0kPa	3.0kPa	3.0kPa	3.0kPa	3.0kPa	2.2kPa	1.5kPa
1800	3.0kPa	3.0kPa	3.0kPa	3.0kPa	3.0kPa	2.2kPa	1.5kPa
1900	3.0kPa	3.0kPa	3.0kPa	3.0kPa	3.0kPa	2.2kPa	1.5kPa
2000	3.0kPa	3.0kPa	3.0kPa	3.0kPa	3.0kPa	2.2kPa	1.5kPa
2100	3.0kPa	3.0kPa	3.0kPa	3.0kPa	3.0kPa	2.2kPa	1.5kPa
2200	3.0kPa	3.0kPa	3.0kPa	3.0kPa	3.0kPa	2.2kPa	1.5kPa
2300	3.0kPa	3.0kPa	3.0kPa	3.0kPa	3.0kPa	2.2kPa	1.5kPa

INTERLOCK TYPE 2

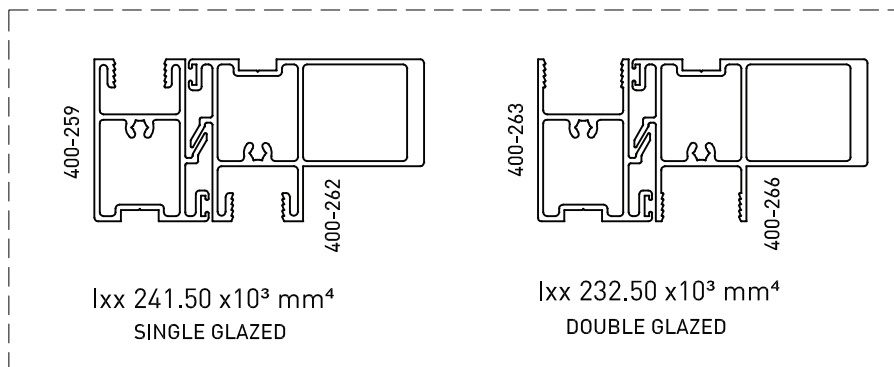

Loading Tables

INTERLOCK TYPE 3 - RESIDENTIAL

Frame Width	900	1000	1100	1200	1300	1400	1500
Frame Height							
1000	3.0kPa	3.0kPa	3.0kPa	3.0kPa	3.0kPa	3.0kPa	3.0kPa
1100	3.0kPa	3.0kPa	3.0kPa	3.0kPa	3.0kPa	3.0kPa	3.0kPa
1200	3.0kPa	3.0kPa	3.0kPa	3.0kPa	3.0kPa	3.0kPa	3.0kPa
1300	3.0kPa	3.0kPa	3.0kPa	3.0kPa	3.0kPa	3.0kPa	3.0kPa
1400	3.0kPa	3.0kPa	3.0kPa	3.0kPa	3.0kPa	3.0kPa	3.0kPa
1500	3.0kPa	3.0kPa	3.0kPa	3.0kPa	3.0kPa	3.0kPa	3.0kPa
1600	3.0kPa	3.0kPa	3.0kPa	3.0kPa	3.0kPa	3.0kPa	3.0kPa
1700	3.0kPa	3.0kPa	3.0kPa	3.0kPa	3.0kPa	3.0kPa	3.0kPa
1800	3.0kPa	3.0kPa	3.0kPa	3.0kPa	3.0kPa	3.0kPa	3.0kPa
1900	3.0kPa	3.0kPa	3.0kPa	3.0kPa	3.0kPa	3.0kPa	3.0kPa
2000	3.0kPa	3.0kPa	3.0kPa	3.0kPa	3.0kPa	3.0kPa	3.0kPa
2100	3.0kPa	3.0kPa	3.0kPa	3.0kPa	3.0kPa	3.0kPa	3.0kPa
2200	3.0kPa	3.0kPa	3.0kPa	3.0kPa	3.0kPa	3.0kPa	3.0kPa
2300	3.0kPa	3.0kPa	3.0kPa	3.0kPa	3.0kPa	3.0kPa	3.0kPa

INTERLOCK TYPE 3 - COMMERCIAL

Frame Width	900	1000	1100	1200	1300	1400	1500
Frame Height							
1000	3.0kPa	3.0kPa	3.0kPa	3.0kPa	3.0kPa	3.0kPa	3.0kPa
1100	3.0kPa	3.0kPa	3.0kPa	3.0kPa	3.0kPa	3.0kPa	3.0kPa
1200	3.0kPa	3.0kPa	3.0kPa	3.0kPa	3.0kPa	3.0kPa	3.0kPa
1300	3.0kPa	3.0kPa	3.0kPa	3.0kPa	3.0kPa	3.0kPa	3.0kPa
1400	3.0kPa	3.0kPa	3.0kPa	3.0kPa	3.0kPa	3.0kPa	3.0kPa
1500	3.0kPa	3.0kPa	3.0kPa	3.0kPa	3.0kPa	3.0kPa	3.0kPa
1600	3.0kPa	3.0kPa	3.0kPa	3.0kPa	3.0kPa	3.0kPa	3.0kPa
1700	3.0kPa	3.0kPa	3.0kPa	3.0kPa	3.0kPa	3.0kPa	3.0kPa
1800	3.0kPa	3.0kPa	3.0kPa	3.0kPa	3.0kPa	3.0kPa	3.0kPa
1900	3.0kPa	3.0kPa	3.0kPa	3.0kPa	3.0kPa	3.0kPa	3.0kPa
2000	3.0kPa	3.0kPa	3.0kPa	3.0kPa	3.0kPa	3.0kPa	3.0kPa
2100	3.0kPa	3.0kPa	3.0kPa	3.0kPa	3.0kPa	3.0kPa	3.0kPa
2200	3.0kPa	3.0kPa	3.0kPa	3.0kPa	3.0kPa	3.0kPa	3.0kPa
2300	3.0kPa	3.0kPa	3.0kPa	3.0kPa	3.0kPa	3.0kPa	3.0kPa

INTERLOCK TYPE 3

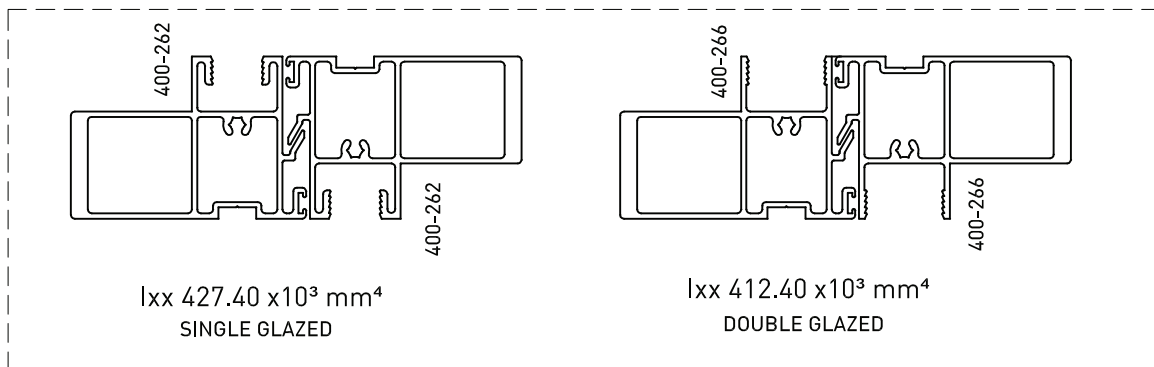

Test Results

424 THERMAVIEW double hung window - 2 lite - 6.38mm lam - pile seals	
Serviceability load	+/-3.3 kPa
Ultimate load	+/-2.3 kPa
Water penetration	300 Pa
Air infiltration @75Pa	+ 0.86 l/s/m ² - 0.91 l/s/m ²
Operating force (initiating)	122.22 N
Operating force (maintaining)	107.41 N
Test sample size	1.5m high x 0.8m wide
Test report number	QMTL 315-901424